



NICK HUMPHREYS
SALES · LETTINGS · STUDENT

SINCE 1986

117b, Loughborough, LE11 5AE
£215 Per Week

Further Information

1 double en-suite bedroom available for the 2025/2026 academic year

Rent, Fees and Terms

£215.00 per person per week INCLUDING BILLS /
£10,750.00 per person per annum INCLUDING bills. 50 weeks - Please contact the office for more details.

Available 1st July 2025

Deposit

No deposit with UK based guarantor*

Inclusive of personal contents insurance*

Location

This ground floor self-contained apartment is located on the edge of the town centre and approximately a 15 minute walk from the University

Living Kitchen

Open plan living/kitchen area with separate bedroom and en-suite shower room

Bedrooms

This property consists of 1 DOUBLE en-suite bedroom, which is bright and airy and includes a double bed, wardrobe, chest of drawers, desk and chair.

Parking

On road parking permit available which can be purchased via MiPermit.

EPC Grade D

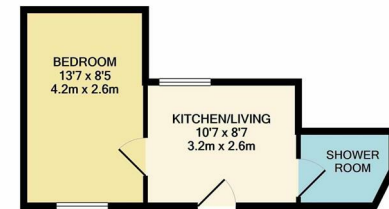

Whilst every attempt has been made to ensure the accuracy of the floor plan contained here, measurements of doors, windows, rooms and any other items are approximate and no responsibility is taken for any error, omission, or mis-statement. This plan is for illustrative purposes only and should be used as such by any prospective purchaser. The services, systems and appliances shown have not been tested and no guarantee as to their operability or efficiency can be given.
Made with Metropix ©2021

